

LAMBERT

Mead

notebook

9½ IN x 6 IN

24.1 CM x 15.2 CM

80 Sheets

College Ruled

06654

The Mead Corporation, Dayton, Ohio 45463



15°C, 29‰

8/21/98 Shilshole Marina - noon low tide  
boat launch docks north end of marina

Botryllids

small *Distaplia* occid. on mussel

Pier T (locked)

Long rope on slip #45

*Corella inflata* +++

Botrylloids <sup>violaceous</sup> sp. on mussels, orange +++

Rope - slip #40

Lots of the above + *Distaplia* +

Rope - slip #16

The above, also very small *Styela gibbsii* +

Orange botryllid

16 tentacles

many tadpoles

# ampullae - 27, 34, ~36 etc

~11 rows stigmata

nt dorsal " rows 2+3 not complete



10 stomach folds

15°C, 32‰

8/23/98 Edmonds Marina 10AM

N23  
rope

Corella inflata +++ or more; large

Distaplia occid. ++

Botryllids +++ Colonies all one color,  
but many colors.  
yellow, orange, lavender,  
deep purple

many mussels  
1 small Diplosoma

Big hose by boat winch - huge numerous  
colonies of Distaplia +++

Net to Buds bait house

Aplidium calif. - 1 colony

Covered marina H

Corella +++

G. covered unlocked float G16

S. gibbsii ++

Corella +++

Botryllids:

8 oral tentacles - 2 long, 2 short, 4 rudim.  
black + grey, oval stars Small: .4mm

1. B. schlosseri

orange stars

8 oral  
tentacles

2. Botryllid sp. with zooids w/ many angullae

orange or yellow colonies

16 oral tentacles 8 rows stigmata

3. Dark purple Botryllid

8 oral tentacles

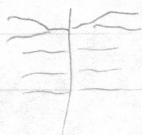

~ 10 rows stigmata

1+2 (or 2+3) incomplete on  
both sides.

high tide 10:15 AM water clear 15°C  
Elliott Bay Marina 32‰

2/28/98 B. schlosseri ++ - both orange  
+ black/gray  
G pier C. inflata ++ - egg on  
Botryllodes sp. Sabellid tubes  
orange, brick red, yellow  
many B. schlosseri on a ~~red~~ kelp frond - various colors  
+ small Distaplia on kelp + many small ones on  
a floating bumper  
Lots of sabellids  
+ Diplosoma - one small on a mussel

A pier - far west  
Many sabellids  
+ 1 large Botryllus on a sabellid  
Many very small Corolla "  
+ 1 very small Styelid gibbsii  
Orange Botryllus <sup>schlosseri</sup> - star shaped  
8 oral tentacles   
2 long, 6 short  
small tadpole, 3 papillae Parapallae  
big eyespot

9/1/98 Des Moines

16.5°C  
32‰

Covered float - Pier L unlocked;  
yacht sale

Slip 37 long rope Also slip 42

+++ Corella w/ Eurylepta

+++ Styela gibbsii

+++ Corona savignyi (?) Many 10+cm long

+++ Botrylloides sp. violaceus

++ Distaplia (?)

++ B. schlosseri - orange stars  
and brown stars

uncovered rope at slip 51 - near end of  
dock  
Corona savignyi w/ more pigment  
white flecks

Bell Harbor Marina  
9/1/98 Downtown Seattle 16°C  
++ Corella 29-30‰  
+++ Botrylloides sp. violaceus  
+++ B. schlosseri

10:15 AM very low tide

21°C  
28‰

9/3/98 Blaine

End of rd - commercial docks

+++ *B. violaceus* - all colors - orange,  
+++ *S. clava* yellow, purple

9/4/98 French Creek Marina 2PM

+++ *S. clava* 20°C  
+++ *B. violaceus* 27‰

+ *D. stylis* - 1 small - on tire

+ *Corella inflata* 1 small "

+++ *B. schlosseri* - both color morphs  
also all black grey/black, & orange

+ *Molgula* <sup>manhattanensis</sup> - 1/4 small, on tire

9/4/98 Nanoose Bay - Snow Hill - Wets

+++ *B. schlosseri* - esp orange - huge colonies 21°C

+ *Corella inflata* - Also black ones 27‰

+ *S. clava* - very small small

Dominated by mussels

small *Strongylocent. drobach*, *Pisaster*

+++ *B. violaceus*

9/8/98

70 mi

16.5°

1) Everett Marina

22°00'

Covered floats - 24°00' ~ 1 ft down

long rope slip 41 dm by mussels

+ small *Coella inflata*

+ *Styela gibbsii*

2) Edmonds 15°, 32°00' long rope

+++ *Botrylloides violaceus* } on gas float

+++ Dist. occid } long rope

+ *Diplosoma listerianum* - on mussel

++ *S. gibbsii* - H covered float

+++ *Coella inflata* esp H covered float

3) Des Moines L dock covered 16.5°, 32°00'

+++ *B. schlosseri* - orange, & dark } several long ropes

+++ *B. violaceus*

+++ *Ciona savignyi*

++ *Coella*

++ *Distaplia* - some very large colonies

++ *S. gibbsii* esp on rope

+ *Boltenia villosa* - 1

*Coella inflata* - from Prince Wm Sound,

Alaska Sept. 1998 coll. by Jim

Carlton for Smithsonian.

Evans Island, Chenega Village Small Boat Harbor

9/7/98. Just west of Montague Island.

ex-SERC panels (Greg Ruiz)



4) Harbor Marina, south end  
of Harbor Is. 16.5°, 25‰

+ Several small *Corella inflata* on a crab trap at  
end of rope

5) Elliott Bay - 5:30 PM, high tide  
& pier (unlocked) 15°C  
*Botrylloides violaceus* 32‰  
*B. schlosseri*

---

9/9 Tacoma - Ole + Charlie's Marina

1) Dr. 10 AM 15.5°C, 25‰

Photos of *schloss.*  
+ marina  
*Botryllus schlosseri* - orange on  
covered dock - very large tubate <sup>on</sup> crab trap  
very long rope on covered float -  
*S. gibbsii* - small  
1 *Distaplia* (?)

2) *Steilacoom* 32‰, 15°  
+ *Balanus villosa* } on a net full of oysters  
+ *S. gibbsii* }  
1 *A. callosa columbiana* - on a mussel

3) Olympia: 17°C  
Boston Hbr Marina 30‰  
Distaplia occid. - huge w/ 2 large  
staplians on a long rope  
also covering bottom of ~~staplians~~  
float

4) Shelton Yacht Club 20°C  
+++ Molgula manhattanensis 29‰ down  
30‰ up  
++ Botryllus schlosseri orange &  
black  
+ Botrylloides violaceus - yellow mottled  
++ Distaplia occid.

↓ 1<sup>st</sup> year to be large colonies according  
to 17-yr residents. Also warmer water  
this yr than previous. the best

5) Fair Harbor Marina 7PM, high tide  
Grapeview 19°C, 31‰  
+++ Botrylloides violaceus - every color morph  
possible

---

9/10 Kitsap Marina 18°C  
Port Orchard 8AM 31‰  
+ Styela gibbsii - on rope + floats  
+ Botryllus schlosseri - saw 4  
- 1 small colony on mussel  
orange

oct 19 98  
10 AM

17°  
32‰

2) Brownsville Yacht Club

- +++ Botrylloides violaceus orange yellow -
- +++ Diplosoma some huge colonies
- + Corella inflata
- + Distylia occid.
- + Styela gibbsii
- + Clona savignyi 3 big ones in sabellid/clumps

3) Seabeck Marina - on Hood Canal

noon 19°C

- +++ Botrylloides violaceus 29‰
- +++ B. schlosseri - orange, black 27.5‰ at 1 meter depth

4) Port Ludlow - 3:15 PM 15.5°

- + Pyura haustor - 1 33‰
- + Styela gibbsii - few
- +++ Corella inflata
- +++ Botrylloides violaceus
- ++ Distylia
- + B. schlosseri
- ++ Diplosoma

5) Port Hadlock 5 PM 14°C 34‰

- + Pyura haustor ++ Distylia
- +++ Botrylloides violaceus 1 Ascidia callosa
- +++ Corella inflata 1 Botryna villosa
- +++ Diplosoma listerianum
- +++ Styela gibbsii

14° , 34‰

- 6) Port Townsend 6 PM
- +++ *Diplosoma*
  - +++ *Botrylloides violaceus*
  - ++ *Chelyosoma productum*
  - +++ *Corella inflata*
  - ++ *Styela gibbsii*
  - + *Ascidia callosa columbiana*
  - + *Distaplia* - abundant on a long rope
  - + *Perophora* - on a *Corella*

9/11

- 1) Cornet Bay, Whidbey Is. 8:45 AM  
1 *Corella* small 13° , 33.5‰  
~ 3 *Botrylloides villosa* "icy, lace"  
lots of scyphistomae, fil. diatoms, Metrid.
- 2) Blaine - unlocked float by office 11:20 AM  
Dredging, in full operation - water very  
muddy. 17° , 30‰
- +++ Long rope - lots of *B. violaceus*,  
large colonies, various colors
  - +++ *Sclera*
  - ++ *Distaplia occid.* }
  - ++ *Corella inflata* } on rope
- 3) Bellingham 19° C , 25‰ - but  
only mussels + barnacles 21‰  
near shore  
3 small *Bot. violaceus* at end of long rope

4) Edison 18.5°C, 5‰  
Botrylloides violaceus on Ulva -  
drift?

5) Cap Sante - <sup>Maine</sup> Anacortes 15°  
++ Penzance 31‰  
+++ Botryll. violaceus  
++ Corella inflata - esp. in a covered float  
S. gibbsii  
+++ Distaplia - on a long line in a  
covered float. Huge colonies

---

9/12 Friday Harbor

1. Old lab floats  
++++ Corella inflata  
++ Botryll. villosa  
+++ Styela gibbsii  
++ Chelyosoma productum  
++ Distaplia occid.  
+ Aglidiem californicum very large colonies on  
++ Pyura haustor a bucket on a rope

2) Shipyard Cove <sup>+ Jensen</sup> 4:30 PM 13.5°C, 32‰  
+ Distaplia occid  
+++ Chelyosoma + A. callosa  
++ S. gibbsii  
++ Pyura haustor  
+ Corella

12°C, 33‰

9/13<sup>1)</sup> Town Docks 9:30 AM

- +++ Chelyosoma
- +++ Botteria
- +++ S. gibbsii
- ++ Corella
- + A callosa
- ++ Distaplia occid
- +++ Pyura haustor
- + Aplid. calif. - large & sabellid tubes - Spring St docks

2) Lonesome Cove 12°, 32‰

- + Chelyosoma productum
- + S. gibbsii
- + Pyura
- + Distaplia

3) Roche Hbr 12.5°, 33‰

- ++ Botteria - old - esp on hoses
- ++ Corella esp new floats! Huge one 6.2cm long x 5cm across siphons largest one
- ++ Pyura - old
- +++ Distaplia
- ++ S. gibbsii - old
- +++ Chelyosoma - old floats
- +++ Diplosoma
- ++++ Botrylloides violaceus - new floats
- ++ Aplid. calif. - hoses

3PM

4) Westcott Bay Sea Farm 16°C, 32‰  
+++ Botryll. violaceus - lots of tadpoles

5) Snug Harbor 13°, 32‰

++ Distylosa  
+ S. gibbsii  
+++ Aplysia calif.  
+++ Diplosoma  
++ Botryll. violaceus  
++ Corella  
+ Pyura haurator

Photo # 9  
Distylosa on a  
Sabellid

6) Lab docks 12°, 32‰ 4:30PM

+++ Aplysia calif. - both yellow + orange  
+++ Distylosa - <sup>nigrescens</sup> but small white colonies very large  
+ Corella inflata  
++++ Chelyosoma - esp on a long rope & tray  
+++ S. gibbsii - on a long rope  
+ A. callosa - ~ 4, some large on a tray  
++++ Botryll. + on a long rope  
++ Aplysia solidum w/ tadpoles

Photos  
10+11  
gibbsii  
Botryll

9/14 Orcas Island

1. West Sound Marina 9:30AM

150  
32‰

++++ Botryll. violaceus - green colors lots of Sabellids  
+++ Diplosoma + Pyura  
+ Corella + S. gibbsii - mostly small  
+++ Distylosa - many small + Chelyosoma

- 2) Deer Harbor Marina 10:20AM 14° 33°W
- +++ Botryll. violaceus } new floats -
  - ++++ Diplosoma } installed April '98
  - +++ Corella
  - ++ S. gibbsii - old floats w/ lots of mussel in water. rye
  - + Cnemidocarpa f. maritima - 1 older float
  - + Bottemia villosa 1 "

- 3) Canyon Quay Marina - also Deer Hbr  
old floats mostly, a few new ones
- +++ Distyfia - small colonies lots of subellips
  - ++++ Corellas
  - + Bottemia
  - + Aglidi calif.
  - +++ Diplosoma
  - ++++ Botryll. violaceus
  - +++ S. gibbsii
  - +++ Pyura - old floats
  - + Cnemidocarpa - 1

- 4) West Beach Resort noon 14° 31°W
- Barnacles, hydrozoa, Zostera

- 5) North Beach Smugglers Cove 14° 31°W
- +++ S. gibbsii } on ropes
  - ++ Bottemia } + Botryll. violaceus
  - ++++ Distyfia } 1 colony on mussel
  - + Corella w/ Eumylesta



6) Rosario 15° 31.5' 00"  
 ++ Distaplia } ropes  
 +++ Corella }  
 +++ Botryll. violaceus }  
 + Boltenia -1 }  
 + Pyura haustor -1 } lots of mussels  
 Diplosoma } barnacles  
 Sabellids

7) Orcaos Ferry dock 12° 32' 00"  
 ++ Corella 3:15 PM  
 ++ Distaplia } lots of big  
 + Boltenia } sabellids  
 Pyura haustor  
 Chelyosoma  
 S. gibbsii  
 A. callosa columbrina  
 Aplid calif.

Bill Paterson - caretaker 378-4992

9/15 1) Fish Creek 9:45 AM  
 + Distaplia 12° 33.5' 00"  
 +++ S. gibbsii  
 +++ Pyura haustor Floats are 9 yrs old  
 ++ Chelyosoma  
 + Boltenia -1

2) Jacksons Beach floats 13° 33' 00"  
 Diplosoma Boltenia  
 Distaplia S. gibbsii

Low tide 9:30 AM 13°, 32.5‰

9/16 Lopez Is. - Fisherman's Bay

- +++ *Corella inflata*
- +++ *Aptid. calif.*
- +++ *Brophora annectens*
- ++ *Pyrus haustor*
- +++ *Aptid. solidum*
- +++ *Diplosoma*
- +++ *Distaplia occid.*
- + *Botryllia villosa*
- ++ *Botryll. violaceus* - on big kelp esp.  
many colors
- + *Chelyosoma* - large old ones

Metridium  
4+  
water very  
green, "thick"

9/16 Anacortes 13° 33‰

- 1. *Skylin Maina* - across from Shannon Pt  
noon
- +++ *Corella* - 4+ on bottoms
- +++ *B. violaceus* - abund on some floats, not  
others
- ++ *Diplosoma*
- SPR++ *Distaplia*
- + *Pyrus haustor* - 1 large

2.

- ++ *Corella*
- + *S. gibbsii*
- + *Distaplia*
- + *Botryll. violaceus*

Down Dakota St,  
13°, 32‰

31‰, 15°C  
(from PSX report)

3. Anacortes Marina 2PM

- +++ Botryd. violaceus !!
- ++ Corella - egg covered floats
- ++ Distaplia - very large

Metridium 4+

Water very green

---

9/23 Vancouver

Reed Pt. Marina  
Port Moody 26‰ mussels, barnacles

9/24 1) Granville Is. Marina 25‰ " "

2) Royal Vancouver Yacht Club 29‰

Stanley Park

+ Corella - a few on a line ~6' down  
mostly barnacles + mussel, a few sponges,  
hydroids, 1 Pissaster

3) Horseshoe Bay 24‰  
mussels + barnacles

4) Nanaimo 16.50, 29‰

Brechin Pt boat launch

- +++ Botryllus schlosseri
- +++ Botrylloides violaceus all colors } lines
- + Styela clava 2
- + Corella inflata

16°, 30‰

5) Pacific Biol Sta  
+++ Botryll violaceus all colors  
huge colonies  
++ Corella infusa  
Metridium - huge #s mussels,  
Pisaster, Sabellid, Pugetia - large

9/26/98 Port Alberni 8‰, 19°  
Mouth of Soanass River  
only a few barnacle

---

10/3/98 ① Kingston Marina 10AM  
Low tide 13‰, 33‰

~~+++ Botrylloides violaceus~~  
+++ Corella infusa  
lots of sabellid, P. 3 aster, Metridium  
mussel

++ Distaplia longline on  
slip #11 - covered float  
next to fuel dock

② Port Gamble - no floats

③ Poulsoy C. 15° 32‰  
water very muddy - apparently normal  
at low tide

Long line across from slip A39 :

+ Distaplia }  
+ +++ Botrylloides violaceus } on line  
++ Styela gibbsii }  
} end of rope

Lots of big Metridium on floats  
(\*) Didemnum SPA? + Didemnum carinulentum - very large colony

San Juan Islands Summer 1999

5/14/99 ① Roche Hbr - never floats only  
+ Botrylloides violaceus - small colonies  
++ Chelyosoma productum  
+ Bottenia villosa

② Smug Hbr  
1 Corolla inflata large  
+++ Distaplia occid - solid wall on  
Huge colonies everything  
1 Chelyosoma productum - large

③ Shipyard Cove Lots of jellyfish  
+ Beroe  
++ Pyura haustor  
+++ Chelyosoma productum  
++ Bottenia villosa  
++ Styela gibbsii  
2 Ascidia callosa - large  
++ Distaplia occid

④ Old lat floats - Capron's Landing  
+++ Styela gibbsii  
+++ Pyura haustor  
+ Corolla - few  
+ Aplidium calif. - on bucket  
+ Distaplia occid  
1 Ascidia <sup>columbiana</sup> callosa - on bucket; large  
+ Bottenia villosa  
+++ Chelyosoma productum  
Also Tubularia ++ large

FHL docks - with Brad Moore  
+ Joehin

June 5, 1999 Aplid. calif. and  
Aplid solidum

esp. abundant in live tanks on floats  
attached to the floats & tubular frames

Also a didemnid with very stubby-  
spined spicules

*Styela gibbsii*

*Pyura hausta*

*Chelysoma productum*

*Ascidia callosa* - several large

*Distaplia occid.* - not common

June 9, 1999 Dredging on Nugget -

CEL and Steve Stricker w/ Dave Duggins  
40 fathoms - 240 ft - off Rock Pt., Lopez Is.

1) *Aplidiopsis panosum* 3 colonies

2 white, one yellowish

Zooids with many large embryos - are  
hatching. As many as 5/zooid

Also a "nest" of veligers in the center of  
the largest colony.

Colonies 27 mm in diam x 17 mm tall

21 mm wide x 16 mm tall

18 " x

Atrial languet wide, cowl-like, w/ 3 small clefts or  
teeth.

Attached by small area basally - a short thick  
peduncle

Tunic clear, no sand

12-13 rows stigmata, no papillae on transverse vessels

As many as 8 embryos in one zooid

Aplidium

2) One grey colony, ~ 6cm long x 2cm wide  
Somewhat crushed.

Zooids very contracted but tiny.

Many have larvae in atrial chamber.

Tunic completely impregnated with sand grains, is quite tough, colorless.

Zooids colorless but stomach yellow/orange, larvae very pale pink.

Zooids densely crowded.

Atrial languet

Parasitic copepods present

---

July 1, 1999 Rock Pt off Lopez, dredge

10 colonies of Aplidiopsis pannosum  
collected by Nugget - Dave Duggins - also  
Brad Davidson of Moody's lab, UW, off  
Lopez.

One small colony is attached to some  
barnacles.

Largest colony has 2 heads. These larger  
colonies are definitely capitata. Largest is  
4 cm across in widest diam, x 2.5 across, x 3.4 cm  
tall of which the stalk is 1.4 cm. Attached  
to sabellid tubes. Small Boltonia or Halocynthia  
hispida (= gibbosa)  
attached to base of one colony.

2 colonies are a little more yellowish than the others;  
all have a globular shape & translucent tunic.  
The zooids are yellow in the 2 colonies. One has  
embryos in the basal portion & 3 dead but  
released tadpoles on its surface, a small colony

has many zooids with apparently 1 larva/zooid,  
incubated in zooids' atrial chamber.

Zooids arranged in more or less circular  
systems around the common cloacal opening, which  
is obscure in contracted zooids.

The 3 tadpoles <sup>have</sup> very yellow body, <sup>esp one part which is probably the stomach.</sup> Very wide  
tail fin, 3 adhesive papillae. Instead  
of lateral angullae, the tadpoles have  
numerous small ectodermal vesicles (see  
Kott '92 p. 508). They are scattered  
over most of the lateral + anterior regions:  
corresponding to Kott's "multiple arc of  
vesicles". One of the tadpoles has begun  
metamorphosis - tail totally withdrawn,  
the 2 little siphons are visible.

Another colony (small, alive, in great  
condition) of the mystery Aplidium found  
in lab from June 9 dredge. Has a  
copepod, live, bright red w/ green eggs - given  
to Shizuko. Botryllophyllus. Colony relaxed,  
preserved. Growing on a piece of barnacle shell.  
One oblong flat system of 31 zooids with 1 cloacal  
opening. 9 rows of stigmata but probably immature.  
Stomach longit. plicated. Zooids very transparent  
except stomach + ascending intestine yellow. Tunic  
with embedded sand but not encrusted. Tunic  
soft, gelatinous, transparent. Atrial languet



when fully extended very long, broad,  
tongue-like & single - no lateral languet.

~ July 20 - Brad Davidson, grad student  
at UW - <sup>Moochie lab</sup> says there are lots of  
Ciona savignyi at Edmonds Marina  
esp. on covered floats.

Aug. 2 - Charley coll. Perophora annectens  
at Fisherman's Bay floats, Lopez Is.  
See disc. by Nishikawa 91. Some zooids  
have a definite short 5<sup>th</sup> row of stigmata.  
In all the largest zooids (4mm max. length)  
the 4<sup>th</sup> row is much longer than the others  
& there are a few stigmata subdivided  
into 2.

Aug. 3 Dredge hauls from Rock Pt off  
Lopez; more colonies of Aplidium  
pannosum most small. Largest one 2cm  
across. Many larvae, & swimming  
tadpoles which are huge - body elongate,  
~1.3mm long. 3 very large sausage-like  
bulbous adhesive organs, no ampullae.  
Some colonies have reddish brown pigment here & there.

Aug. 4 Dredge at Peavine Pass for  
Balanus nubilis for Chris Ashley. Many  
colonies of Aplidium sp. - colorless or  
grey with embedded sand. Zooids have

a large # of longitudinal stomach plications <sup>~14</sup>

In one colony, 2 kinds of parasitic copepods:  
the same red/green Bothylophylus and  
also Haplostoma - several. <sup>at least 6</sup>  
~12-14 rows stigmata

8/3/99 Dredge Rock Pt off Lopez - also  
collected an unid. didemnid, reddish  
brown w/ white spicules, on a small <sup>Megtilimera</sup> clam.  
Didemnid colony is full of a <sup>red</sup> parasitic  
copepod w/ red eggs.

8/4/99 - Large colonies of Metandrocarpa  
taylori with brooded embryos + tadpoles  
on the Balanus nubilis. Tadpoles also  
bright red. The 3 adhesive papillae  
are very short



Some of the Aplousis pannosum colonies  
have scattered reddish brown pigment in the  
surface. These are opaque colonies. One  
colony is yellow, with zooids + embryos quite  
yellow. Numerous colonies coll. 8/3, up  
to 4cm across. Many shapes, sizes, +  
subtle color variations but all full of  
embryos. One colony has a Haplostoma type  
parasitic copepods - given to Shizuko.

Peavine Pass - Is between Blakely Is (north end)  
and Obstruction Is. - always dredge at  
9-10 fathoms for the *Balanus nubilis*.

At Rock Pt - about 1/2 way up west side of  
Lopez - always dredge at 46 fath.

8/4/99 some colonies of *Aplidium* sp sandy tunic  
on the *Balanus*<sup>nubilis</sup>. Also a large *A. callosa*.

*Aplidium* grown in lab, fixed 8/30. Lives well in water table.

8/28/99 *Cystodytes lobatus* white & orange/pink  
color morphs from 40 fath. San Juan Channel  
in front of Strathmann's.

5/27/00 Rock Pt - north end of  
Pt. D. ...  
*Polysiphonia* ...  
*Chlamydomonas* ...  
*Styela* ...  
*Pylaeus* ...

5/27/00 Spring Pt ...  
West of ...  
*Corallia* ...  
*Diplommatina* ...



110C  
330700  
5/25/2000 Orcas Is. marina  
near ferry dock  
Bayhead Marina

mussels, a few large sabellids, barnacles,  
algae + fil diatoms. No visible tunicate

Ferry landing fuel dock

*Distaplia* - lots on a strip of  
bumper

a few *Tubularia*

*Balanus rubilis* on floats

*Mytilus* ?

*Metridium* } common

big sabellids - common

5/27/00 Rocket Hbr "new" floats

++ *B. violaceus* several colors

*Boltenia villosa*

*Chelyosoma productum*

*Styela gibbsii*

*Pyura haustor* 2

5/27/00 Saug Hbr

+++ *Distaplia* beard

*Corella inflata* - 2, 1 large

*Diplosoma listerianum* on a sabellid

Claudia's PSX 2000 expedition

- Totten Inlet
- ① Taylor Mussel Rafts 5/19/00  
Didemnid - *Didemnum* <sup>sp. A</sup> ~~annulatum~~  
*Corella inflata*  
*Boltenia villosa*  
*Botrylloides violaceus* w/ tadpoles
- ② Steamboat Island, Totten Inlet 5/20/00  
Didemnid - *Didemnum* <sup>sp. A</sup> ~~annulatum~~
- ③ Palix Mouth 5/21/00 Willapa Bay  
*Botrylloides violaceus* - purple
- ④ Palix #3 5/21/00  
*Botrylloides violaceus* - purple
- ⑤ Nahcotta, <sup>WA</sup> 5/22/00 Long Beach Peninsula  
*Botrylloides violaceus* - several colors

Aug. 7, 2000 Boston Hbr

- 1) Botrylloides <sup>violaceus</sup> +++ various colors 22.5°C  
mussels 31‰  
gastropods  
B. schlosseri black + yellow  
Ascidella aspersa - some are pink  
Ciona intestinalis - very small  
Styela clava  
[sides of a tall steel float]  
Molgula <sup>manhattanensis</sup> - sm. - on large tree

- 2) Boston Harbor Hotel 20.5°C  
Rowes Wharf 30‰  
S. clava ++  
B. schlosseri +++  
Botrylloides +++ many colors violaceus  
Molgula <sup>manhattanensis</sup> ++  
Ascidella +++ aspersa  
Ciona intestinalis +++

- 3) Deer Island sewage treatment plant lots of mussels  
lots of Tubularia Not many dock  
Dock high sided ascidians 20.5°C  
Next to sandy beach - open 31.5‰  
++ Botrylloides exposure  
+ Botryllus schlosseri black  
++ Ascidella aspersa - a few various sizes

1 *Ciona* small

④ Constitution Hbr in Chunks fever  
Very rich in ascidians - lots of floats

*Byrrhinia*

## *S. clava* - at end of rope

## *Botrylloides*

22°C

## *Botryllus schlosseri*

18% surface, 29.6%  
bottom

## *Ascidella* / *Ascidia* on ropes + on  
*S. clava*

+ *Ciona intestinalis* very large

## ~~*Ciona* *scutigeri*~~

1 *Molgula*

Lab U Mass Boston on Dorchester Bay



Aug. 8, 2000



- ① Gloucester floats State Pier & float
- +++ *S. clava*
  - ++++ *Botryllodes violaceus* various colors
  - +++ *Ascidella aspera*
  - ++ *Molgula manhattensis*
  - +++ *Botryllus schlosseri* black
  - + *Molgula citrina* 4

Photo #11 - *S. clava* w/ assorted other ascidians on it held by Andy Cohen

- ② Cape Ann Marina 22°C
- ++++ *Botryllodes violaceus* 30.5%00
  - +++ *S. clava* not as many as site ①
  - ++++ *Molgula manhattensis* large
  - +++ *Ascidella aspera* huge
  - +++ *B. schlosseri*
  - +++ *C. intestinalis* - some orange
  - + *Molgula citrina* 3 specimens

- ③ Beverly - Tuck's Pt. (from dock)
- +++ *S. clava* 21°C
  - +++ *B. violaceus* 32%00
  - lots of mussels, *Asterias forbesi*, Sm. brown Metridium
  - + *C. intestinalis*
  - +++ *Molgula manhattensis* esp. on hydroids
  - + *Ascidella aspera*
  - ++ *B. schlosseri*
  - + *Molgula citrina* w/ larvae, 2 specimens

④ Hawthorn Marina Salem 21.5°C  
 + + + B. schlosseri 31‰  
 + + + B. violaceus  
 + + + M. manhattanensis large extremely abundant  
 + + + C. intestinalis  
 + + + S. clava  
 + + + Diplosoma listerianum  
 + + + Ascidiella aspera

= Aug. 9 2000 22°C  
 31‰

② Baypoint Marina, Quincy  
 + + + B. violaceus very abund  
 + + + B. schlosseri very abund. the most so far  
 + + + Molgula manhattanensis very abundant + very large  
 + + + S. clava esp on outer floats many are young right at water's edge  
 not many large ones  
 largest one 35mm across = max recorded size

③ Public pier, Duxbury 22.5°C  
 + + + B. violaceus 32‰  
 + + + Molgula manhattanensis esp. under dock  
 + + + Styela clava  
 + B. schlosseri  
 + Ciona intestinalis 1 large

④ Town wharf floats, Plymouth 21.5°C  
31%<sub>00</sub>

++ Botrylloides violaceus

+++ Molgula manhattanensis

+++ B. schlosseri - yellowish beige and

++ Styela clava also black

① MWRA Pellet Plant, Quincy - coll. by  
collected off big barge - not a  
good site. J. Carlton

+++ Styela clava - many small + 1/2 grown

Botryllus schlosseri - both black & cream

Botrylloides violaceus

Molgula manhattanensis

Had to climb down a ladder

Aug. 10, 2000

23°C

31%<sub>00</sub>

① Woods Hole Coast Guard

+++ Styela clava

+++ B. violaceus

++ B. schlosseri

cunna (a wrasse) eats Molgula + young

Ciona - according to Larry Harris

who has done stomach contents. This is

published.

++ Aplidium <sup>constellatum?</sup> - esp. on mussels. Has appeared  
only in the past few yrs according to  
Carlton

Didemnum <sup>vervillum</sup> ~~tatum~~ (2) sp

1 *Ascidella* - small

~~1 *Styela* ? - brown, on mussel~~

1 *Ciona* - on same mussel

1 *Molgula* - overgrown by beige  
*Didemnum tutarium* sp

2 *Molgula* not overgrown  
*Perophora* - 1 sm. colony on mussel

(2) Eel Pond, Woods Hole 24°C  
30‰

+++ *Ascidella aspersa* both pink & colorless

+++ *Ciona intestinalis*

++++ *Molgula manhattensis*

++++ *Aplidium stellatum*

+++ *Botrylloides violaceus* w/ larvae

+++ *Styela clava*

+++ *Diplosoma* a lot on one tire <sup>outer side</sup>

(3) Barnstable Hbr 23.5°C, 27-28‰

++++ *Molgula manhattensis*

+++ *Botryllus schlosseri* black

+++ *Styela clava* - towards bottom of rope

+++ *Botrylloides violaceus* a huge mat on a crab trap

photo # 19 slide + 18 - *Molgula* on a rope

Largest *Molgula* 41mm across, w/ long siphons, coll by J. Carlton

19.5°C

31%<sub>00</sub>

(4) Sandwich Hbr

+++ *S. clava* on ropes huge

+++ *B. violaceus*

+++ *Ascidrella aspersa* huge

++ *Ciona intestinalis*

+++ *Botryllus schlosseri* many color morphs

+++ *Diplosoma*

+++ didemnid - large beige colonies

*Molgula* sp. (1) small citrina

*Aplidium constellatum* 1 sm. colony

*Aplidium stellatum* 1 or more sm. colonies

Didemnid: huge mats

8-9 coils of sperm duct

spicules densest in superficial layer, small  
like Van Name p. 87

No spicules basally. *Didemnum* sp  
~~*tutorium*~~

*Aplidium stellatum*

13 stomach folds apparently regular

10-11 rows stigmata

no sand embedded

Aug. 11, 2000

Dock put in  
in March

23°C

32‰

(10) Mass Maritime Acad. Floats

- +++ B. violaceus
- +++ Didemnum ~~sp.~~ <sup>vexillum</sup> (?) huge mats lower down on apiling
- + Molgula manhattensis
- ++ Ciona intestinalis
- +++ Botryllus schlosseri
- + Styela clava 1 sm.

(16) Bourne Marina 23.5°C, 31‰

- +++ B. violaceus
- +++ S. clava
- +++ Molgula manhattensis
- ++ Ciona intestinalis
- +++ Botryllus schlosseri
- + Ascidiella aspera 1 small

(2) New Bedford state pier float

- +++ B. violaceus
- +++ S. clava
- +++ B. schlosseri
- + Molgula manhattensis 1 small

(3) Tripps Marina, Westport, Mass. 25.5°C

- + Ciona intestinalis 26-27‰
- + Styela clava
- +++ Didemnum ~~sp.~~ <sup>vexillum</sup> slide photo #20
- +++ Botrylloides violaceus
- ++ Botryllus schlosseri
- + Perophora viridis 2 colonies, one on a dead mussel
- + Styela canopus
- + Molgula manhattensis

salinity very stratified

bottom  
23.5°C 29‰  
25°C, 17‰ surface

④ Fall River - Battleship Cove  
Side of a submarine

- ++ *Molgula manhattensis* - at end of rope
- +++ *Botrylloides violaceus*
- + *Acididiella aspera*
- ++ *Botryllus schlosseri*

### Rhode Island

8/14/00 Melville East Passage

① Portsmouth Marina Yachting Center

- +++ *Molgula manhattensis*
  - +++ *Ciona intestinalis*
  - +++ *Botrylloides violaceus* many colors
  - ++ *Styela clava*
  - +++ *Acididiella aspera*
  - +++ *Botryllus schlosseri*
- Huge biomass of ascidians everywhere in marina

② Narragansett Boat Club 21°C  
No ascidian 20‰

③ India Point - Providence Boatleggers Marina 21°C  
+++ *Molgula manhattensis* 30‰  
Photos of 2 swans & a mallard

④ Edgewood Yacht Club 20°C, 27‰  
on ropes, hanging bumpers;  
+++ *Molgula manhatt*  
+ *Botryllus schlosseri*  
+ *Botrylloides violaceus* - 1 sm.

21.5°C  
30‰

(5) Cove Haven Marina

- ++++ *Molgula manhattana* Hugetts
- + *Botrylloides* ? 2 small colonies
- + *Botryllus schlosseri*

Aug. 15, 2000 by Larry base 2

(1) ~~Newport~~ Coasters Harbor Is. 20°C, 33‰

- +++ *Styela clava* 41° 30' 16.5" N, 71° 19' 34.3" W
- +++ *Diplosoma* - very abund
- +++ ~~Botryllus~~ *Botrylloides violaceus*
- ++ *Ascidella aspersa*
- + *Ciona intestinalis* common
- +++ *Sidemnum* <sup>vexillum</sup> ~~tutakian~~ - outer end of outer docks by entrance

(2) Roger Wms Univ 21°C, 31‰

Crab traps: large mats of  
*Botrylloides violaceus*  
& *Ascidella aspersa*

(3) Bristol - Colt State Park 21°

- +++ *Ascidella aspersa* 31.5‰ (small)
- ++ *Botryllus schlosseri*
- + *Styela clava* - small 2
- + *Molgula manhattana* SIS



verillum

Notes of *Didemnum luteum*?

8/11/00 sta. 1 - Mass Maritimo

Has tadpoles, ~ 6 lateral anguillae / side  
3 adhesive papillae

Zooid - about 8 spirals of sperm duct

Single testis

Thoran firmly attached to tenia by  
oral siphon

Apparently no atrial languet

4 rows stigmata

Atrial opening a gaping hole

Aug. 16, 2000

① Wickford - west side 21.5°C

+++ *Botrylloides violaceus* 30%  
surface

+++ *Molgula manhattensis*

+++ *Styela clava* mostly small mostly at end of marina

+++ *Botryllus schlosseri* facing away from harbor entrance

② Allens Harbor, N. Kingstown 21.5°C, 29.5‰

++ *Styela clava*

+++ *Molgula manhatt*

++ *Botrylloides violaceus*

③ Warwick Cove Marina 21.5°C, 30‰  
Warwick RI

++++ *Molgula*

+++ *Styela clava* - some huge

++++ *Botryllus schlosseri*

+ *Botrylloides violaceus*

++ *Styela canopus* - on a quahog bag  
and an old piece of  
styrofoam

④ Fort Getty pier

++ *Botrylloides violaceus* on rocks  
full of larvae

also on mussels on pilings

++ *Styela clava*

8/17/00 Prudence Is. Tuharuf 20°C

Dominated by mussels 32‰

+ *Ascidrella aspera* a few small

+ *Ciona intestinalis* 1 sm.

++ *Botrylloides violaceus* - on rocks  
on shore also

8/17/00 Prudence Is. - Potter's Cove 21.5°C, 32‰

+ *Molgula manhattensis* - few on a net

+ *Ascidrella aspera* rare (1) <sup>bag</sup> on float  
small

8/24/00

Southern Calif.

19.5°C

35‰

① Cabildo Marino Museum Boat

- +++ Botrylloides violaceus several colors, larvae
- +++ Styela clava
- ++ Sympyegma reptans
- +++ Ascidia ceratodes
- +++ Ciona savignyi
- +++ Botryll. diegensis
- +++ Styela plicata
- ++ Botryllus schlosseri black
- no S. canopus
- ++ ~~C.~~ Ciona intestinalis small mostly on side of boat  
Some larger.
- + Styela gibbsii plain red siphons; no stripes
- + Microcosmus squamiger

② Watchon Marina - now Cabrillo Way Marina

- Diplosoma <sup>2 color morphs</sup> bisterianum ++ 21°
- slide photos of a large piece of rug covered w/ plicata, clava etc  
photos 24 + 25 = A. ceratodes on mussel - note ridge of tentacles  
Botrylloides diegensis +++ 34‰
- Styela plicata +++
- Styela clava +++
- Ascidia ceratodes ++
- +++ Aplidium sp. ~ 9 rows stigmata many larvae both orange & white morphs
- +++ Ascidia ceratodes
- +++ Ciona intestinalis
- +++ B. schlosseri black
- +++ B. violaceus
- + Molgula <sup>ficus</sup> verrucifera + Distaplia occidentalis small heads of larvae. purple colonies
- + Ascidia zara
- + Ciona savignyi

34% 21.50

③ Newmark's Marina, Wilmington

- + *Ascidia ceratodes*
- +++ *Botrylloides violaceus* also white
- +++ *B. diegensis*
- +++ *Aplidium* Calif. big whitish colonies
- +++ *Styela clava* huge
- +++ *Ciona intestinalis* huge
- +++ *Styela plicata* huge
- +++ *Diplosoma listerianum*
- ++ *Aplidium* sp. red zooids w/ transparent tunic
- + *Molgula* - ~~resucifera~~ *Sicus*
- + *Ciona savignyi* !
- + *Microcosmus squamiger*
- + *Ascidia zara*

Island Yacht Anchorage, Wilmington

④ *Ciona intestinalis* +++ huge 32% 23°C

- +++ *Styela plicata* +++ 23°C
- +++ *Ciona savignyi*
- +++ *Diplosoma listerianum* Photos
- +++ *B. violaceus* slides 10+11
- +++ *B. diegensis* *C. intest + C. savignyi*
- ++ *Ascidia zara* under water
- ++ *Molgula* - *manhattensis*
- + *Styela clava* young
- + *Styela gibbsii* plain red siphons  
small, 3 or 4 but w/ gonads

8/25/00 Port Hueneme

19.5°C

36‰

(1) ~~Jada's Landing~~ (on Victoria St.) <sup>Renamed</sup> Cisco's

+++ Botryllus schlosseri black

+++ Ciona intestinalis

~~Molgula~~

+ Botrylloides diegensis

+ Styela clava

+++ Ascidia ceratodes

+ Styela plicata

+ Diplosoma

+ Molgula verrucifera <sup>ficus</sup> C. Monnot 11/30/05

+ Chelyosoma productum (1)

++ Aplidium californicum

++ Botrylloides violaceus large colony on Ulva

(2) Anacapa Isle Marina <sup>dock</sup> 20°C

+++ Botrylloides diegensis 36‰

+++ Botrylloides violaceus

+++ Ascidia ceratodes

+++ Aplidium californicum white pinkish or

+++ Styela clava esp on outer slips. large ones & many small ones

+++ Diplosoma - 2 color morphs

+ Microcosmus squamiger

+++ Molgula <sup>ficus</sup> ~~verrucifera~~ esp on our docks

++ Ascidia zara

+ Botryllus schlosseri black

++ Styela plicata most abundant + huge on outer docks

+ Ciona savignyi

+++ Ciona intestinalis

24<sup>th</sup> St. Natl City  
inner ~~edge~~ river corner of  
junction of ramp & float

J St Boat launch floats Chula Vista  
2 ropes one at @ end of the 2 floats  
north rope OK 2000 on W side near end of float

Fiddlers Cove 2 ropes  
NE corner of C19 & at very end.

~~Barnacle Bill Harbor~~ do

on float straight out from office E7  
also a wire at E7

Shelter do, see diagram

Coronado Yacht Club rope at C19

South Shore boat ramp Mission Bay  
Rope at end of south float

Bahia Pt Mission Bay  
Santa Clara - rope by concrete pier at left end  
of float

Shelter do diagram

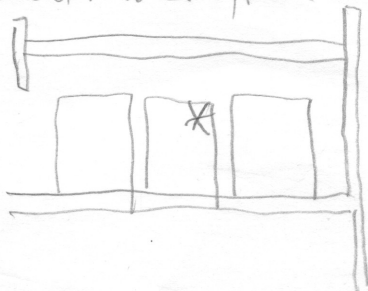

Handwritten notes, likely bleed-through from the reverse side of the page. The text is mostly illegible due to fading and bleed-through.

Handwritten notes, likely bleed-through from the reverse side of the page. The text is mostly illegible due to fading and bleed-through.

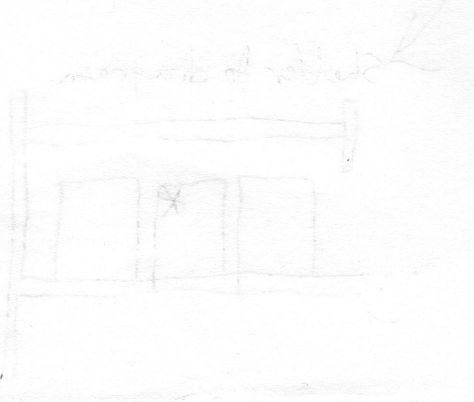

very open coast here - purple urchins,  
sea stars, large anemones

- (3) Port of Hueneme 19°C 35‰  
+ *Ciona intestinalis*  
+ *Styela gibbii* - 1 small  
++ *Styela clava*  
+ *Ascidia ceratodes*  
++ *Botrylloides violaceus*

Photos slide #11, 12, 13 *Ascidia*  
*ceratodes* from the 3 sites in 1 dish

- 8/26 San Diego Bay  
(1) J St. Chula Vista 27°C  
north rope OK on N side  
near end of float 37‰

- +++ *Diplosoma listerianum*  
+++ *Microcosmus squemizer*  
+++ *S. plicata*  
++++ *Ciona savignyi*  
+++ *Polychinum constellatum* 2 color morphs  
brownish purple  
& blackish  
+++ *Ascidia* sp. green short siphons, large animal  
++ *Perophora* on *Zostera*  
+++ *Molgula verrucosa* frus  
+++ *Styela canopus*  
+ *Styela clava* few but large  
+ *Botrylloides diegensis* rare, small  
+ *Ciona intestinalis* large but rare  
++ *Polyandrocarpa* large colonies on rope esp on rope,  
but also on north float  
+ *Botrylloides violaceus* small, rare



26°C, 36‰

(2) F. Adlers Cove Navy Yacht Club C19 ropes  
both OK

- +++ Styela clava extremely abundant
- ++++ Polyandrocarpa sp on rope but everywhere
- ++ Botrylloides diegensis
- +++ Diplosoma listerianum
- +++ Microcosmus squamiger
- + Botrylloides violaceus
- +++ Styela canopus
- ++ Ciona intestinalis
- + Synglymma reptans on <sup>our</sup> end rope
- +++ Styela plicata
- + Distaplia occidentalis 1 sm. colony
- + Perophora
- + Botryllus schlosseri large black colony
- +++ Ciona sariganyi near shore esp on line
- +++ Molgula ~~verrucifera~~ fens
- + Aplidium calif yellow - on a buoy
- + Psidium sp. A 2 large ones on "
- + Botryllus sp.

(3) Shelter Is. Rope OK 23°, 35‰

- ++ Botrylloides perspicuum = ~~sm~~ huge colony on rope
- ++ Botrylloides violaceus some w/ larvae
- +++ Botrylloides diegensis
- +++ Styela plicata
- ++ Polyclidium constellatum
- +++ Polyandrocarpa 3 or 4 specimens
- ++ Aplidium sp. large, similar
- +++ Botryllus schlosseri

- + *Ascidia ceratodes* (1)
  - ++ *Distygia occidentalis* both orange & mottled purple
  - +++ *Styela clava*
  - + *Ascidia zara*
  - ++ *Symplozoma reptans*
  - ++ *Perophora*
  - +++ *Aspid. calif.*
  - +++ *Molgula verrucifera* Ficus
  - +++ *Ciona intestinalis*
  - ++ *Ciona savignyi*
  - + *Diplosoma*
  - ++ *Ascidia* sp. inner floats
  - + + *Styela canopus*
- No *Meroosmus* - searched thoroughly

*Botrylloides perspicuum* (= *firmus*) has many tadpoles. Each has 8 very long empullae. <sup>4 per side</sup> Heart is beating in the tadpoles, which are incubated inside the zooids. Body of tadpole ~ 0.8-0.9 mm in length. 3 pointed adh. papillae. Adult systems in small ovals. 2<sup>nd</sup> row of stigmata is complete. Testis anterior to ovary.

At Shelter Island on outermost float was a round float, <sup>or bumper</sup> covered with numerous spp of ascidians + other inverts. Several photos taken (slides).

8/27/00 Baja California 22.5°C  
35‰

- ① Ensenada Sportfishing Marina  
Juanitas doce dominated by mussels  
but seen on water  
But floats full  
of inverte
- +++ *Ciona intestinalis*
  - +++ *Styela plicata*
  - +++ *Styela clava* } esp on ropes + p. logs  
1m+ below water line
  - +++ *Aplidium californicum*
  - +++ *Botrylloides violaceus*
  - +++ *Botryllus schlosseri*
  - +++ *Botrylloides diegensis*
  - +++ *Diplosoma*
  - +++ *Polyandrocarpa*

- ② Coral Hotel + Marina 21.50°C  
35‰
- +++ *Styela clava* - esp on piling Water much  
cleaner than
  - +++ *Botrylloides diegensis*
  - +++ *Styela plicata* - esp on piling
  - +++ *Polyandrocarpa* - on floats
  - + *Botryllus schlosseri*
  - + *Ciona intestinalis* (2)
  - +++ *Diplosoma*
  - + *Aplidium* <sup>calif</sup> 1 sm colony
  - + *Microcosmus* (1)
  - + *Ascidia ceratodes*  
on rope + on mussel  
3 small

8/28/00

20.5°C, 36‰

① Seaforth, Mission Bay - by Hyatt  
lots of old ropes here Quivira Basin

- +++ Styela plicata
- ++ Botrylloides perspicuum (= B. firmus)
- ++ Diplosoma
- ++ Botrylloides dregensis
- + Botrylloides violaceus (1)
- ++ Ascidia ceratodes
- ++ Styela clava
- ++ Molgula verrucifera fucus
- ++ Botryllus schlosseri
- +++ Ciona intestinalis
- ++ Ascidia sp.?
- ++ Polyandrocarpa
- + Aplidium californicum
- + Anidra zara (2)
- ++ Ciona savignyi - very large, abundant - inside a large crab-trap
- + Microcosmus

② San Dieguito Lagoon - no ascidians. 18.5‰

③ Agua Hedionda Lagoon - Snug Harbor  
Mauna - just east of Hwy 5

Dominated by mussels

- ++ Aplidium californicum 22.5°C
- +++ Didemnum vexillum on mussels (1) 36‰  
on mussels (1)
- + Botryllus schlosseri has systems like D. perlucidum
- ++ Diplosoma
- + Styela clava (1 large)
- + Microcosmus (2 large, 1 sm)

(H) Oceanside + br 35.5‰, 22°C

- a. Police floats & nearby
- ++ Styela clava
  - +++ Polyanthracarpa
  - ++++ Botrylloides diegensis
  - +++ Styela plicata
  - ++ Diplosoma
  - + Botryllus sp. tubular <sup>at siphon</sup> orange
  - +++ Ascidia - ceratodes <sup>on mussels & ropes</sup>
  - ++ Microcosmus
  - +++ Molgula ~~seruicifera~~ fucus
  - ++ Botryllus = chlosseri

Most of these ascidians on long ropes installed by someone (?) quite a while ago  
Maybe 1 yr

8/29/00 Marina del Rey - Bora Bora

- Float A 1501-1528 OK Ropes 1 A 701
- +++ Styela plicata <sup>esp on ropes!</sup> OK ② Betw 706 & 708 on float AS 25
  - ++ Ascidia ceratodes (2 rope stripped)
  - +++ Botrylloides diegensis 22.5°C, 35‰
  - ++ Molgula ~~seruicifera~~ <sup>fucus</sup> on ropes
  - + Botryllus schlosseri - black, orange, "calico" colonies
  - + Botrylloides violaceus 1 colony w/ tadpoles
  - ++ Ciona intestinalis small - red eggs!
  - +++ Aplidium californicum - both the white & the clear w/ orange zooids
  - +++ Diplosoma Aplidium sp.

- + *Ascidia zara*
- ~~*Ascidia ceratodes?*~~
- + *Styela clava* very rare

(2) King Hbr Redondo Beach 23°C, 36‰  
 Rope D30, F11 - Did not  
 D30 OK get onto float

- +++ *Styela plicata* Longhose
- ++ *Ciona intestinalis* E18 -
- ++ *Aplidium calif.* excellent
- + *Styela clava*
- ++ *Botryllus schlosseri*
- +++ *Botrylloides drégenis*
- ++++ *Diplosoma* Largest = 4cm
- + *Microcosmus* Several large on long hose
- + ~~*Ascidia ceratodes?*~~
- x++ *Polyandrocyra* on a long hose F8
- + *Botrylloides violaceus?*

lots of garibaldi around rocks as  
 always

8/30/00 Long Beach 19.5°C, 36‰

① Pier by Long Beach Fire Dept floats  
Close to LA hbr entrance Several very long ropes

- +++ Aplidium calif.
- ++ Ciona intestinalis
- ++ Botrylloides diegensis
- ++ Styela plicata
- + Styela clava
- + Distaplia occidentalis Full of larvae  
sm. colonies  
orange, & mottled purple
- + Diplosoma
- + Microcosmus 2 very small

② Long Beach downtown marina SKL floats

- +++ Diplosoma 21°C, 36‰
- +++ Botrylloides diegensis - incl. 1 colony all orange but w/ thin rings around siphon
- +++ Styela plicata
- +++ Botryllus schlosseri - several color morphs
- +++ Ciona intestinalis small
- ++ Styela clava
- +++ Aplidium calif on outer floats
- + Molgula ~~manhattanensis~~ <sup>Sioux</sup> (2)
- + Ascidia ceratodes
- +++ Molgula manhattanensis

③ Hyatt LB - shallow pond Rainbow Lagoon  
Full salinity

- +++ Microcosmus
- +++ Botrylloides diegensis
- +++ Styela plicata
- + Ciona intestinalis
- + Aplidium calif
- + Molgula manhattanensis

35900  
20.5°C  
④ Impound Marina

- ++++ Bot. liegensis
  - ++++ S. clara
  - ++++ S. plicata
  - ++ Aplidium calif.
  - ++++ Ciona intestinalis
  - ++ Ascidia ceratodes quite large
  - ++++ Diplosoma
  - ++++ Bot. violaceus - orange colony w/ larvae  
also purple + other colors
  - ++ Polyandrocarpa
  - ++ Botryllus schlosseri
  - ++ Distaplia occidentalis orange, also mottled
  - + ~~Ascidia zara?~~
  - + Molgula verrucifera fucus
  - + Styela gibbsii (2) on a line
- No Microcosmus or Symploema  
Toas of tunicates.

B. liegensis - one orange + brown colony with  
embryos in early tailbud. 2 embryos/zooid,  
incubated inside the body



8/31/00 Alamitos Bay 22°C, 35‰

① Colorado Lagoon - upper end of Alamitos Bay

- +++ *Styela plicata*
- +++ *Molgula manhattanensis* on *Zoobotrym*
- ++ *Aplidium californicum*
- ++ *Ciona intestinalis*

② Alamitos Bay <sup>LB Yacht Club</sup> 21°C, 35‰

- ++ *Styela clava* Near to but not the same floats as our Sea Grant site
- ++ *Botrylloides violaceus*
- ++ *Botryllus schlosseri*
- ++ *Botrylloides diegensis*
- + *Ciona savignyi*
- + *Ascidia ceratodes*
- ++ *Ciona intestinalis*
- + *Ascidia* sp. (yellow eggs)
- ++ *Distaplia occidentalis* variegated w/ purple
- ++ *Molgula verrucifera* <sup>ficus</sup>
- + *Polyandrocarpa* on long rope
- ++ *Microcosmus* "
- + *Styela plicata*
- + *Styela canopus* 1 large

③ Huntington Hbr. <sup>Corner of PCH + Warner</sup> Yacht Club

- +++ *Ciona intestinalis* 22.5°, 35‰
- +++ *Molgula verrucifera* <sup>ficus</sup>
- ++ *Styela plicata*
- ++ *Botrylloides diegensis*

- ++ Botryllus schlosseri
- ++ Ascidia zora
- ++ Microcosmus
- + Diplosoma listerianum
- + Aplidium calif
- + Ciona savignyi
- ++ Botrylloides violaceus

(4) Dinner Huntington Hbr at Edinger & Bonaire Circle

- +++ Styela plicata
- ++ Diplosoma Las Fuentes subdivision
- ++ Botrylloides diegensis
- ++ Molgula verrucifera Ficus
- ++ Aplidium calif
- ++ Botrylloides violaceus
- + Styela clava
- ++ Botryllus schlosseri
- ++ Ciona intestinalis
- + Ciona savignyi
- + Ascidia
- ++ Microcosmus

Feb. 17, 2001

Parksville, Vanc. Is.

No Styela clava at French  
Creek Marina

---

April 9, 2001 Des Moines Marina

Lots of Ciona savignyi on covered  
floats. Very abundant. Many sizes  
small to large.

---

Friday Harbor summer 2001

---

May 28, 2001. 2 colonies Trididemnum sp  
on a yellow rope & a mussel FH town  
dock. Rusty brown in color - new  
species. With larvae.

May 25, 2001 Ascidia columbiana large  
Shipyard Cove float. Also 6 June.

June 29 Dredge Rock Pt off west side of  
Lopez Is. C. Lambert coll. 33-42 fath. gravel  
Agolidiopsis pannosum: both yellow &  
white colonies <sup>& a clear one.</sup> 11 colonies <sup>The largest is 16mm</sup> across.

3 Ascidia paratropa, 1 small, with <sup>large</sup> tunic papillae  
over the entire test. 2.5 cm in length.  
Tunic very clear, clean. Also a large  
one 4.5 cm in length, papillae not so long  
or numerous, + a fat one 3.5 cm long.

48° 29.6' N, 122° 57' W

- ② Second dredge haul, Flat Pt off Lopez on sand. One *Aplidiopsis pannosum* very clear, small on a hard substrate.  
48° 32.9' N, 122° 55.4' W 10-25 fath

On first dredge haul, also collected a large colony of the *Aplidium* n. sp. - grey or nearly colorless, tunic with embedded sand grains. Pink egg masses are in some of the zooids (not copepods). Relaxed in menthol (not too well) + fixed in 10% SW buffered formalin.

Notes on *Aplidium* sp. coll. 6/29

Zooids in more or less circular systems

Sand grains embedded are mostly clear (quartz) and black. Are densest at base.

Up to 13 bright pink eggs are at the base of the thorax under the branchial sac in many zooids; others have large larvae in the atrial chamber at an advanced stage.

Longest zooids (preserved) are 8mm but thoraxes contracted somewhat.

10 rows of stigmata in the largest mature zooids - is a very consistent #.

Unhatched tadpoles only ~ 600µm long.

Zooids completely colorless + transparent

except stomach + lower part of ascending intestine which are a deep yellow.

Stomach has 11-12 regular longitudinal plications that are parallel + run the full length of the stomach.

Anus bilobed

About 12 stigmata /  $\frac{1}{2}$  row; anterior rows have 10-12.

Larva - a few vesicles between the adh. organs

Zooid: 2 large muscle bands run longitudinal, the full length of the zooid ventrally.

All of the *Aplidiopsis* colonies collected 6/29 are not yet reproductive, but appear to be coming out of a resting state. The guts + intestines are empty (=not feeding) and the abdomen posterior to the gut loop is filled with opaque white nutritive? cells. In one colony the thorax is fully formed but gut still empty, though most of the nutritive cells seem to be used up.

July 11, 2001 One large *Styela coriacea* on a canvas strap, ~2m depth, hanging off FHL floating dock. Preserved.

8 cm long in longest direction. Has larvae

July 24, 2001 Collected several colonies of Trididemnum alexi n. sp. from the same yellow rope on the town dock, boat slip E-33, at a depth of 0.5-2 m. Largest darkest colony was near the end of the rope, overgrowing a Pyura haustor. Another colony on a Chelyosoma productum. Some colonies on the rope itself. At least a dozen colonies were observed, most of them small & left in situ.

July 25 Dredge San Juan Channel  
1 colony Cystodytes lobatus - very clear hard tunic, not many spicules. Superficially looks a lot like the dredged Aplidium californicum. Also a pale pink C. lobatus colony. See entry for 8/28/99, same location 40 fath. - both colors.

Aug. 2 SEM of T. alexi spicules - focus not great, background janky on plain stub. New prep of spicules from 5/28/01 <sup>colony</sup> still alive in lab. After burning 10 min, treated with bleach 5 min, rinse ethanol. Drops in 100% EtOH placed on a double stick carbon stub cover, and dried spicules sprinkled on the other carbon sticky stub cover.

Aug. 6 SEM using TMax 100 roll film.  
No photos - could not focus.

Aug. 6 Dredge for *Balanus nublis*  
Upright Channel, 5 fathoms. No  
*Aplidiopsis* but 2 large grey thick  
colonies of *Aplidium*, apparently *A. solidum*,  
with ~ 15 rows of stigmata, long postabdomen,  
total zooid length 1-1.4 mm maybe. No  
larvae.

Also 2 didemnid colonies, very  
thin, slightly pale pink. *Didemnum*  
*carinulentum*? Single testis w/ ~ 9  
turns of the sperm duct. 4 rows stigmata,  
atrial opening but no siphon, common cloacal  
cavity thoracic. Spiacles with rounded short  
points, ~ 7 in a focal plane at widest diameter.  
Many sizes of spiacles in tunic, but most ~ 28-  
40  $\mu$ m. One large one seen, 70  $\mu$ m, and many  
smaller than 28  $\mu$ m also. Living zooids yellow.  
Branchial siphon w/ 6 pointed lobes.

Aug. 8 Dredge Pt. Caution <sup>San Juan Channel.</sup> 62-52 fath.

1 small colony *Aplidiopsis pannosum*.  
Rounded head 16 mm in diameter, 20 mm tall.  
Several circular systems. No larvae.  
Mud-sand-shell bottom. Dredged north from  
Strathmann's. This colony has a wider base than  
most. Tunic transparent - can see zooids.

Aug. 29 Collect 2 large colonies of Trididemnum alexi from the yellow rope at the 7th town dock, slip E 33. About 15 cm from the water surface, near and at the lower end of the rope.

Zooids have a <sup>small</sup> sperm duct + testis, a few have an egg; no larvae seen.

8/30 Many color slide photos taken of colony surface of new T. alexi colonies. Distance between oral siphons is  $\approx 1$  mm.

8/31 Took roll of Tmax 100 120 film on SEM of T. alexi spicules. Technician worked on it all day Wed - seems to work great for focus but JEOL 35 neg unusable because of streaking - diff. light values.

---

9/5/01 French Creek Marina  
+++ Styela clava big! Very abundant  
++++ B. violaceus - many colors  
++++ Corella inflata - in ropes esp.  
++ Distylia occid. purple - some colonies very large  
Botryllus schlosseri (?) lobes - 2 color



morphs: bright orange, and black. The latter comes in 2 patterns - either brownish black around the oral siphons and white in the center or vice versa.

9/7/01 Blaine Marina

+++ *Styela clava* - many sizes including many that are very large

++ *Botryllus schlosseri* orange

+ *Distygia occid.*

+++ *Botrylloides violaceus* - many colors

++ *Corella* in slats - only in heavily shaded surfaces between the concrete float sections, as on the innermost floats (Gate 1). This is a newest set of floats, added < 3 yrs ago.

Heavy cover of mussels.

Gates 1 + 2 are locked but #3 has no rock yet.

Very different situation at Fr. Creek + Blaine from St. Island where *B. violaceus* has been noticeably absent this year or nearly so.

# Vashon Island

9/23/2001 Quatermaster, 31,5°7'00  
Burton: Mariana 15°C

+++ Botrylloides violaceus  
Many colors  
some large sabellids  
Very abundant mussels + barnacle  
white small anemones  
" " cucumbers  
1 small Styela sp.

(2) Dockton Park  
water a lot cleaner but  
same invertebrate community. More  
abundant large sabellids. Only  
ascidian is *B. violaceus*.  
2 *Styela* sp. small  
+ *Distaplia* occid. - few sm. colonies

9/23/01 Pt Defiance Pk <sup>Tacoma</sup> ferry dock area -  
Yacht Club 15°C, 32‰

Covered float - on rope:

+++ *Corella inflata* - also on other ropes  
+++ *Cona savignyi* Very abundant on a  
metal cross piece for a berth  
in a covered float  
+ *Distaplia* occid. on various ropes  
Also *Botrylloides violaceus* on various floats  
*Diplosoma listerianum* on another rope

4/6/02 Sandwich town beach  
washed up didemniids - sent by  
M<sup>o</sup> Carman - see emails 4/4/02  
4/8/02  
5/8/02

apparently *Didemnum* sp.  
badly preserved, very contracted  
yellow, 4 rows stigmata  
no testis, no larvae  
spicules superficial only, sparse  
most of colony semi-translucent, thick,  
w/o spicules.

mcarman@whoi.edu

Brittany, France

7/22/02 Perros-Guirec 18.5°C

- ## *S. clava* *Ciona intestinalis* with red spot
  - ### *A. aspersa* *Molgula socialis*
  - ## *B. schlosseri* many color morphs + *Diplosoma listerianum*  
black & tan colonies
  - + *Didemnum* sp. + *Botrylloides leachi* bright orange  
eggs, no larvae
- all very abundant on ropes

also *Corella eumyota*  
*Lissoclonium purpuratum*

[For rest of records from France, see  
8 pages further on in this book.]

- Aplidium glabrum* (1) small round clear cushion
- + *Trididemnum cereum* large, thick, dark mottled
- + *Lissoclonium perforatum* greyish or light lavender,  
flat, 5cm

# Vancouver Island

① 9/23/02 French Creek Marina

3/4 high  
tide

11 AM

+++ *Styela clava* ++

30‰, 14.5°C

+ *Corella inflata*

+++ *Botrylloides violaceus* - large w/ larvae  
many colors

++ *B. schlosseri* - orange, black + tan

++ *Distoplia oculi* purple, ochre

1 *Styela gibbsii* on tire

② Nanoose Bay First Nations Marina

3 PM

+ *Styela clava*

28‰, 15°C  
(? - refractometer 2‰ too high  
on 9/27/02)

+ *Botryllus schlosseri* - orange

+++ *Aurelia* jellyfish

many mussels + *Metridium* - dominants

*Pisaster* on outer floats

+ *Corella inflata* } ~ 2m down on log

1 *Botlenia* } rope

③ Pacific Biol. Sta. - Nanaimo 3:30 PM

*Corella*

*Botrylloides violaceus*

④ Nanaimo marina

++ *B. schlosseri* - grey + black + orange

+++ *Botryll. violaceus*

1 *Corella inflata* small

*Pisaster* + mussels

Vanc. Is. - continued

- 9/24/02 30‰, 14.5°C  
① Ladysmith - Dry Green 10 AM covered & uncovered floats  
## *B. violaceus* - mostly small, many colors  
~~lots of tiny, unknown 2 colors~~  
+ *B. schlosseri* - sm. colonies orange  
+ *Molgula* (5) - on a float Largest 3cm x 3cm  
+ *Styela clava* 4 large on a piece of fire hose + 1 tiny on a rope  
Dominant *Didemnum* mussels + huge *Metridium*

- ② Maple Bay Marina noon  
*Styela clava* covered & uncovered floats  
*B. violaceus*  
*Coella in Stata*  
5 *Molgula*. Largest 3cm across and 3.7cm tall, including expanded long oral siphon

- ③ Cowichan Bay Maritime Centre 15°C, 29‰ 2 PM  
old floats - almost 100% mussels  
At end of long rope:  
~12-15 stolidobranchs - *S. truncata* with larvae  
1 *Distaplia occid.* tiny

- ④ Mill Bay Marina 14.5°C, 30‰  
Dominated by mussels  
## *B. violaceus* - esp on old concrete float  
Some *Balanus nubilis*  
Seals (harbor seals) on some old floats

also 5 *Styela truncata* on long hose. Largest one dissected 4cm long x 1.5cm wide. 3 broods. Embryos has possibly from 2 cell to hatched tadpole

⑤ Canoe Bay Marina 11.5°C, 31‰  
many covered floats on hose

## *Distygia oculifera* - many small with large basal portions

### *Coella inflata*

+ *Styela gibbsii*

## *Chelyosoma productum*

+ *B. violaceus*

+ *Bottena villosa* 1

+ *Styela truncata* ?

+ *Cnemidocarpa* 1

*Diplosoma listerianum*

*Asplidium californicum*

*Thalassidroma baleyii* 1

*Ascidia columbiana* 1

on a large black float bunched

+ on *Mytilus*  
+ on *Chelyosoma*  
on the *Mytilus*

wrapped around the *Mytilus* - ~ 10cm in length  
Heavily in soil trated by burrowing amphipods.  
Apparently no larvae.

14.5°C, ~32‰

⑥ North Saanich (N. Sidney) marina

### *B. violaceus* - with larvae many colors

### *Coella inflata*

### *Diplosoma*

# Victoria

Sal = 33‰

9/25/02

T = 11.5°C

① West Bay Marina 9AM

- +++ *B. violaceus* - large colonies, many colors
- ++ *Perophora* - many colonies on a float
- ++ *Distaplia* - bright orange, + purple
- slide photos br. orange *Distaplia*
- " " *Perophora*
- digital - small float w/ *Botrylloides*
- " " *Perophora*
- Styela gibbsii*
- Pyura haustor*

② Johnson St. Wharf <sup>floats</sup> 10AM Sal. 33‰  
T 11.5°C

- +++ *B. violaceus*
- + huge #s of large Sabellid *Eudestyliia*
- + *Molgula manhattensis* 5 small
- +++ *Corella inflata*
- + *Distaplia occid.* small
- + *Styela gibbsii* several very small on
- + *Ascidia columbiana* - 1 small Sabellid tube
- ++ *Perophora* - on sabellid tube
- + *Diglossoma* - on " " "

T = 11°C

Sal = 33‰

③ Fisherman's Wharf finger #1 (oldest)

- on long line { *B. violaceus* ttt
- Coella inflata* ttt
- Styela gibbsii* ttt
- Perophora* ttt
- Distaplia occid.* ttt
- Boltenia* +
- Pyura haustor* ttt

Also swab  
*Styela*  
*truncata*  
 a. 3cm long  
 with brooded  
 larvae & single  
 long vessel between  
 folds. 3 collected

Digital of *Coella*

Lots of big *Eurylepta* in *Coella*

③ *Tripl. demman alexi* on plastic on finger between #6 & 7, south side

- Ascidia columbiana* ttt some very large
- ↳ Largest colony 2cm thick, 5½cm long in longest direction. No larvae
- All 3 colonies close tog. on white plastic - overgrowing some moribund *Distaplia* and lots of worm tubes

④ Oak Bay Marina - 1:30 PM T 10°C Sal. 33‰

- ttt *Distaplia occid.* - on sabellids
- many large sabellids
- lots of cyphostomae - *Aurelia* & sabellids
- tt *Perophora* on sabellids ↓ under docks
- Chelysoma productum* ttt on crab tray
- + *Coella* - 2 large
- + *Boltenia villosa*



11°C, 33‰

(5) Jooke area  
Becker Bay - Pacific Lono Marina

+++ *Distaplia occid.* - mainly purple  
some colonies encrusting, no  
stalk

+ ~~unknown compound~~ (*Distaplia regressed*)  
see sample

1 *Corolla inflata* large

+ *Perophora*

(6) Cleanuk Marina 4:15 PM

Becker Bay - protected inner area

*Pyura haustor* } on old cages

*Boltenia villosa* }

*Styela gibbsii* }

(7) Pelder Bay Marina

4 *Styela truncata*

(8) Sunny Shores Marina - v. red  
tide + lots of detritus mat on  
surface

T = 16°C

Sal = 33‰

Long line - *Distaplia* +++

- few small *Distaplia*  
colonies

- otherwise all  
mussels ++++

Ciona - live - collected by  
Cathy + Yogi Carlsfeld

4/13/02 + 4/16/02 Meyer's Pass +  
Smith Inlet (central coast) BC

50ft All *C. savignyi*. ID verified 11/7/02  
Endostylar appendage absent, pharyngo-epicardiac  
openings close to appendage + far from esophagus.

8/23/02 Sechart Inlet BC, 40ft  
several hundred collected, some with  
hydroids in oral siphon (*Entocrypta*, now  
called *Bythotiarra huntmani*)

9/28/02 Many photos taken w/ 200 ASA  
35mm Kodachrome and with  
Nikon digital of the Cionas.

Largest on stake 9cm long

2<sup>nd</sup> 5.3cm long

3<sup>rd</sup> 6.9cm long

Photos w/ 2 animals: 9cm + 6.9cm

10/2/02 Installed 4 15ft ropes at  
town dock, with a wt at the end  
of each. Slips C 32, C 48, E 35, E 51.

fingered siphons  
white + purple color.

France

18.5°C

Aug. 8, 2002 Perros-Guirec floats + ropes

- +++ *Ciona intestinalis* very large + abundant
- +++ *Didemnum* sp. aff. *vexillum* - with mature larvae
- Diplosoma listerianum*
- Trididemnum cereum*
- Botryllus schlosseri*
- Ascidella aspera*
- 2 pink stolidobranchs
- Corella* - eumyota
- +++ *Styela clava*

dig. photos taken  
by Sveta

8/14/02 Camaret-sur-Mer  
long ropes

16°C  
high tide

- +++ *Phallusia mammillata* huge
- Molgula socialis*
- ++ *Styela clava* - few
- Ascidella aspera*
- +++ *Ciona intestinalis*
- + *Didemnum* sp. aff. *vexillum*
- ++ *Lissoclinium perforatum* - greyish lavender
- +++ *Corella eumyota* some dense clumps. Siphons very orange, fairly long.
- + *Diplosoma listerianum*  
no botryllids seen, no *Trididemnum cereum*

7/22/02 Perros Guirec

18.5°C

- S. clava*
- A. aspera*
- B. schlosseri*
- Diplosoma* - black + tan forms
- + *Botrylloides leachi* bright orange
- Didemnum* sp.
- C. intestinalis* - red spot
- Molgula socialis*
- Lissoclinium purpuratum*

New England  
for Nahant Workshop

Oct. 10, 2002

- ① Sandwich Harbor, Cape Cod with Bob Miller, grad student U Mass Boston

15.5°C  
33.5‰  
+++ *Ascidella aspersa*  
+++ *B. violaceus* - many colors, w/ larvae  
++ *Diplosoma listerianum*  
+++ *Didemnum* sp. - the mystery one - esp. abundant + large on lower pilings  
+ *Ciona intestinalis*  
+ *B. schlosseri* - black form

- ② Woods Hole - from the collectors  
white encrusting didemnaid on rocks + shells

<sup>dredged  
60 ft</sup> *Aplidium pellucidum* - huge sandy colonies looking exactly as Van Name described them (after Verrill)

*Aplidium stellatum* - "sea pork" - several huge pale yellowish-white cakes, thick, attached as Verrill said, "as if by the edge of a thick plate" - so they are upright.

*Didemnum* sp - long lobes growing around algae etc

*Ascidella aspersa*

*Ciona intestinalis*

*Molgula manhattensis* large colonies growing with *Didemnum* sp  
*Aplidium constellatum* - reddish with purple embryos - exactly as described by Van Name

Collected on Oct 7 by Bob Miller in Maine  
around Nahant:

Difemnum sp  
Molgula manhattensis  
Molgula citrina - with broods (some  
bright orange embryos)  
Ciona  
Ascidella  
Styela clava  
Aplidium glabrum

① Town dock Beverly  
Oct. 13 - with Larry Harris raining  
+++ Ciona intestinalis  
+++ Diplosoma listerianum  
+++ Styela clava  
++ Ascidella aspersa  
+++ B. violaceus  
+ B. schlosseri - black + grey  
lots of mussels, sm. brown Metridium, filament diatoms  
a few Asterris farbesii all over everything

② Hawthorn Marina Salem 16.5°C 35‰  
checked refractometer  
+++ B. violaceus - many colors  
++ Molgula manhattensis large esp abundant on  
long poles  
+++ S. clava ++ Diplosoma  
listerianum  
+++ Ciona intestinalis  
++ Ascidella aspersa  
+ B. schlosseri

36 ‰ - ?

13°C

Newcastle Coast Guard pier floats  
(will soon be torn down)

Oct. 14 ① Portsmouth NH

+++ *Didemnum* sp - since winter 2001

+++ *Ciona* intest.

+++ *Diplosoma* - since 1993

++ *B. violaceus*

+ *B. schlosseri* black + grey  
lots of mussels

② Rye Harbor State Marine 13°C 36 ‰?

+++ *Diplosoma*

+++ *B. violaceus* - many colors

++ *B. schlosseri* - black + grey

lots of mussels

+ *Molgula* - many small on mussels  
probably *M. citrina*

Oct. 15 Darling Marine Center

++ *Didemnum* sp

+++ *B. violaceus*

*B. schlosseri*

+++ *Molgula* *provisionalis*

+++ *Ciona* *intestinalis* - reproductive, orange eggs

Oct. 16 Hantsman Mar Sci Centre, NB

① *Ciona* *intestinalis* <sup>reproductive orange eggs</sup> } on trees  
*Molgula* } at St Andrews  
*Ascidia* *callosa* } Bird Sta

② Town pier floats - on kelp 10.5°C  
B. schlosseri - 2 large colonies black &  
C. intestinalis grey  
Molgula - orange

Jack Fife

3670-2  
 13°C 30% flower collected at this point  
 Oct 14 - 10:00 AM - 10:30 AM  
 111 - *Malva sylvestris*  
 112 - *Dianthus barbatus*  
 113 - *30*  
 114 - *B. subulnensis* that 4 g. left. Jack the rip. but 4 g. left.

(1) Raynolds State Museum 10°C 36%  
 115 - *Dianthus barbatus*  
 116 - *B. subulnensis*  
 117 - *B. subulnensis*  
 118 - *Malva sylvestris*  
 119 - *Malva sylvestris*

Oct 15 - Durham Mar Sci Center  
 120 - *Dianthus barbatus*  
 121 - *B. subulnensis*  
 122 - *B. subulnensis*  
 123 - *Malva sylvestris*  
 124 - *Cornus californica*

Oct 16 - Henderson Mar Sci Center 18  
 125 - *Cornus californica*  
 126 - *Malva sylvestris*  
 127 - *Aspidistra californica*



Items for collecting

Kugel pad + cushion

thermometer

refractometer + plastic pipette

plastic bags

ice chest

towels

bucket

camera - OM 2 w/ slide film  
digital

paper towels

notebook + pencil

disposable plastic gloves

label paper

magnifier loop

# Mileage

|           |                              |         |
|-----------|------------------------------|---------|
| 8/21      | Shilshole                    | 10 mi   |
| 8/23      | Edmonds                      | 40 mi   |
| 8/28      | Elliot Bay Marina            | 25 mi   |
| 9/1       | Des Moines Marina + downtown | 53 mi   |
| 9/8       | Everett                      | 70 mi   |
| 9/9-9/14  | Pug Sound Exp.               | 373 mi. |
| 9/14-9/16 | "                            | 175 mi  |
| 10/3      | Poulsbo                      | 54 mi   |
|           |                              | <hr/>   |
|           |                              | 840     |

5/12/99 Seattle to FHL start 78420

1 Newport

$$\frac{40}{64} = \frac{x}{800}$$

$$\begin{array}{r} 64 \overline{) 40.0} \\ \underline{384} \phantom{0} \\ 160 \\ \underline{128} \\ 320 \end{array}$$

$$\frac{32000 = 64x}{64}$$

320

Whittaker

First *Ascidella*

*aspera* ~ 20 yrs  
ago

Clava - right after  
Korean war

$$\frac{X}{800} = \frac{0.1}{100}$$

$$\frac{X}{800} = \frac{0.1}{100}$$

$$\frac{X}{800} = \frac{0.1}{100}$$

3.20

What is the  
First A-Cell  
Space - 200  
95 = 200

Aug. 7 { 0806 Molgula man  
0804 " "

0816 Molgula Stgela

0802 M. J. ...  
0802 M. J. ...

---

**California State University, Fullerton**  
Fullerton, California 92634-9480

---

0810 M. J. ...

Photos

Aug. 3 0593 B. viol many colors  
0595 "

0602 B schloss  
0567 "

Aug 5 0680 S clava  
0683 " +  
0704 A. stellatum

Aug 6 0722 B schlosseri  
0735 D lahillei





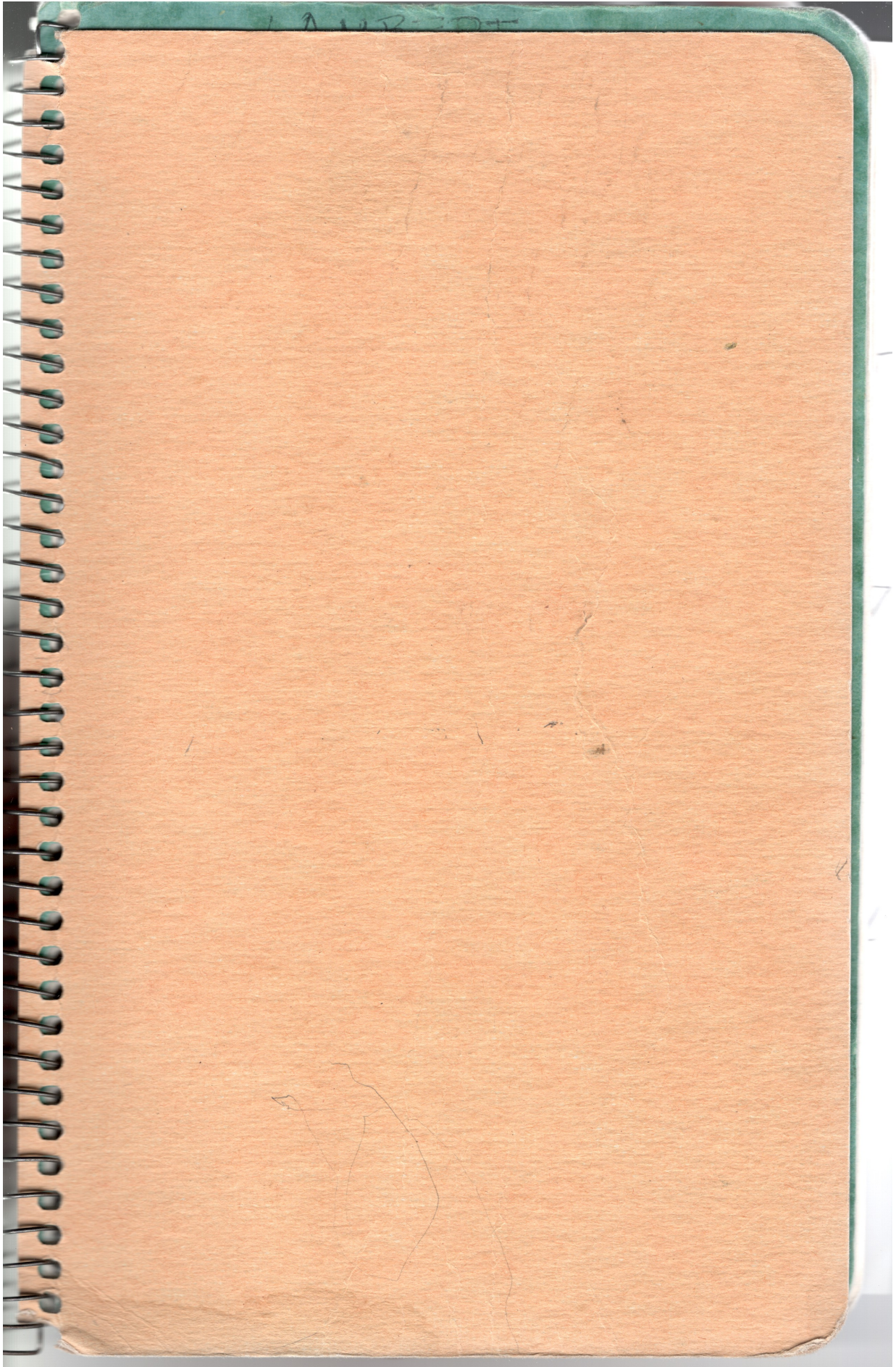

Mead

notebook

9½ In. x 6 In.  
80 Sheets  
College Ruled

06654



THE MEAD CORPORATION, DAYTON, OHIO 45463